

ELECTROWELDED GRATING MODULAR PANEL

for Residential/Industrial use

B.B. mm HxS	Conn.	Dimensions mm	Galvan. kg/cad	Piece No Packaging	Maxim. Load
PANEL Mesh 25x76 mm	○ 4mm	150x1000	3,7	25	Class 4
	○ 4mm	200x1000	4,6	25	Class 3
	○ 4mm	250x1000	5,5	25	Class 2
	○ 4mm	300x1000	6,5	25	Class 1
	○ 4mm	400x1000	8,3	25	Class 1
	○ 4mm	500x1000	10,2	25	Class 1
	○ 4mm	600x1000	12,1	25	Class 1
	○ 4mm	700x1000	13,9	25	Class 1
	○ 4mm	800x1000	15,8	25	Class 1
	○ 4mm	900x1000	17,6	25	Class 1
	○ 4mm	1000x1000	19,5	25	Class 1
	○ 5mm	250x1000	9,5	25	Class 4
○ 5mm	300x1000	11,2	25	Class 3	
○ 5mm	400x1000	14,5	25	Class 2	
○ 5mm	150x1000	8,2	25	Class 4	
○ 5mm	200x1000	10,4	25	Class 4	
○ 5mm	250x1000	12,5	25	Class 4	
○ 5mm	300x1000	14,7	25	Class 4	
○ 5mm	400x1000	19,0	25	Class 3	
○ 5mm	500x1000	23,3	25	Class 2	
○ 5mm	600x1000	27,7	25	Class 2	
○ 5mm	700x1000	32,0	25	Class 2	
○ 5mm	800x1000	36,3	25	Class 1	

GRATING CLAMP PATENTED

non slip

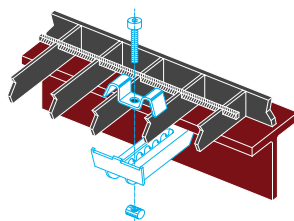

Galvanized grating clamp patented Baldassar Model for mesh 21 - 25 mm

GRATING CLAMPS STANDARD

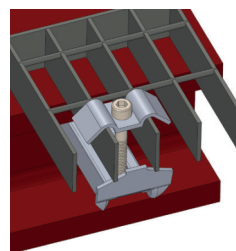

Galvanized grating double clamp Baldassar Model for mesh 21 - 25 mm

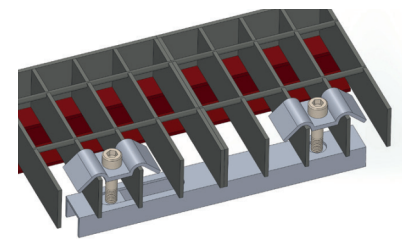

Galvanized grating double clamp Baldassar Model for mesh 21 - 25 mm



Class 1 – Compact crowd pedestrian load
D.M. 14/01/2008 - 3.1.4
Chart 3.1.II - Category E.
Dynamic load 600 daN/m²
Material: Steel S235JR
Sigma yield strength = 23,5 daN/mm²
Sigma comparison = 22,38 daN/mm²
Max. deflection = 5mm
Max. deflection = 1/200 di Ln



Class 2 - vehicle
D.M. 14/01/2008 - 3.1.4
Chart 3.1.II - Category F
Dynamic load 1000 daN on imprint
200x200 mm total ground mass
up to 3000 kg
Material: Steel S235JR
Sigma yield strength = 23,5 daN/mm²
Sigma comparison = 22,38 daN/mm²
max. deflection = 5mm
Max. deflection = 1/200 di Ln



Class 3 – Light truck
Dynamic load 3000 daN on imprint
400x200 mm ground total mass
up to 6000 kg
Material: Steel S235JR
Sigma yield strength = 23,5 daN/mm²
Sigma comparison = 22,38 daN/mm²
max. deflection = 5mm
Max. deflection = 1/200 di Ln



Class 4 – Heavy trucks
Dynamic load 9000 daN on imprint
600x250 mm ground total mass
up to 45000 kg
Material: Steel S235JR
Sigma yield strength = 23,5 daN/mm²
Sigma comparison = 22,38 daN/mm²
max. deflection = 5mm
Max. deflection = 1/200 di Ln